

### CAT Shank

With internal coolant-lubricant supply

Chucks for thread mills with taper shank according to **ASME B5.50, UNC drawbolt thread (CAT)** and internal coolant-lubricant supply.

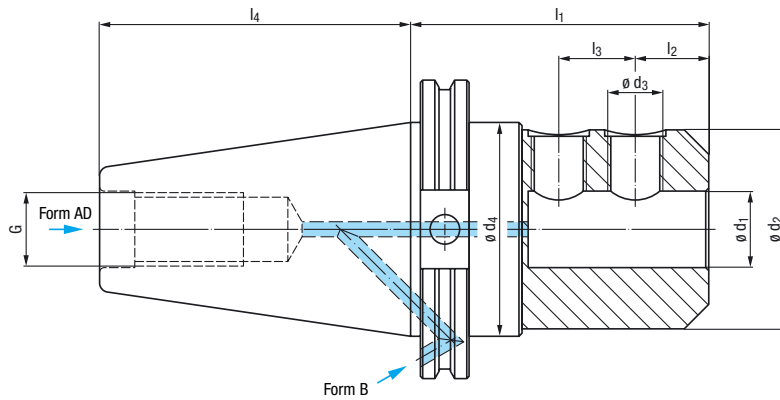

Catalog No.											G608	
mm	$\varnothing d_1$ inch	Taper Size	$\varnothing d_2$	$\varnothing d_3$	$\varnothing d_4$	inch $l_1$	$l_2$	$l_3$	$l_4$	G	Article Number	
6	0.236	CAT 40	0.984	M6	1.750	2.392	0.709	—	2.687	5/8 - 11	GZ514311.06006	●
		CAT 50	0.984	M6	2.750	2.417	0.709	—	4.000	1 - 8	GZ516311.06006	●
8	0.315	CAT 40	1.102	M8	1.750	2.392	0.709	—	2.687	5/8 - 11	GZ514311.08006	●
		CAT 50	1.102	M8	2.750	2.417	0.709	—	4.000	1 - 8	GZ516311.08006	●
10	0.394	CAT 40	1.378	M10	1.750	2.785	0.787	—	2.687	5/8 - 11	GZ514311.10007	●
		CAT 50	1.378	M10	2.750	2.811	0.787	—	4.000	1 - 8	GZ516311.10007	●
12	0.472	CAT 40	1.654	M12	1.750	2.785	0.886	—	2.687	5/8 - 11	GZ514311.12007	●
		CAT 50	1.654	M12	2.750	2.811	0.886	—	4.000	1 - 8	GZ516311.12007	●
14	0.551	CAT 40	1.732	M12	1.750	2.785	0.886	—	2.687	5/8 - 11	GZ514311.14007	●
		CAT 50	1.732	M12	2.750	2.811	0.886	—	4.000	1 - 8	GZ516311.14007	●
16	0.630	CAT 40	1.890	M14	1.750	2.982	0.945	—	2.687	5/8 - 11	GZ514311.16007	●
		CAT 50	1.890	M14	2.750	3.008	0.945	—	4.000	1 - 8	GZ516311.16007	●
18	0.709	CAT 40	1.969	M14	1.750	2.982	0.945	—	2.687	5/8 - 11	GZ514311.18007	●
		CAT 50	1.969	M14	2.750	3.008	0.945	—	4.000	1 - 8	GZ516311.18007	●
20	0.787	CAT 40	2.047	M16	1.750	2.982	0.984	—	2.687	5/8 - 11	GZ514311.20007	●
		CAT 50	2.047	M16	2.750	3.008	0.984	—	4.000	1 - 8	GZ516311.20007	●
25	0.984	CAT 40	2.559	M18 x 2	1.750	3.809	0.945	0.984	2.687	5/8 - 11	GZ514311.25009	●
		CAT 50	2.559	M18 x 2	2.750	3.835	0.945	0.984	4.000	1 - 8	GZ516311.25009	●
32	1.260	CAT 40	2.835	M20 x 2	1.750	4.163	0.945	1.102	2.687	5/8 - 11	GZ514311.32010	●
		CAT 50	2.835	M20 x 2	2.750	4.189	0.945	1.102	4.000	1 - 8	GZ516311.32010	●

With internal coolant-lubricant supply

**BT Shank**

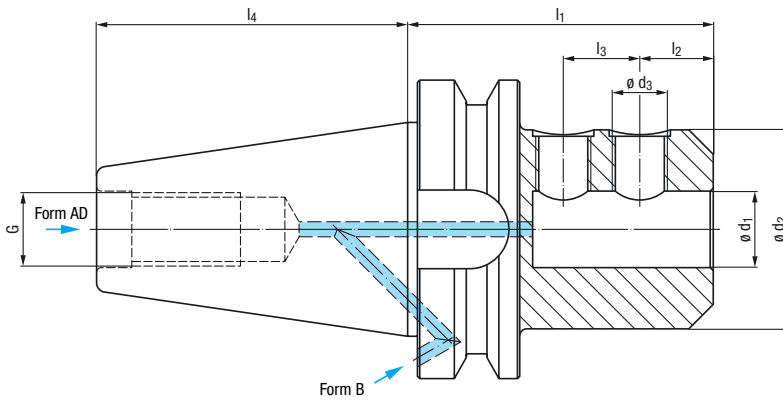

Chucks for thread mills with taper shank according to **JIS B 6339 (MAS 403 BT)** and internal coolant-lubricant supply.

Catalog No.										G609	
mm	ø d <sub>1</sub> inch	Taper Size	ø d <sub>2</sub>	ø d <sub>3</sub>	l <sub>1</sub> inch	l <sub>2</sub>	l <sub>3</sub>	l <sub>4</sub>	G	Article Number	
6	0.236	BT 40	0.984	M6	2.307	0.709	—	2.575	M16	GZ544311.06005	●
		BT 50	0.984	M6	3.236	0.709	—	4.008	M24	GZ546311.06008	●
8	0.315	BT 40	1.102	M8	2.307	0.709	—	2.575	M16	GZ544311.08005	●
		BT 50	1.102	M8	3.236	0.709	—	4.008	M24	GZ546311.08008	●
10	0.394	BT 40	1.378	M10	2.307	0.787	—	2.575	M16	GZ544311.10005	●
		BT 50	1.378	M10	3.236	0.787	—	4.008	M24	GZ546311.10008	●
12	0.472	BT 40	1.654	M12	2.307	0.886	—	2.575	M16	GZ544311.12005	●
		BT 50	1.654	M12	3.236	0.886	—	4.008	M24	GZ546311.12008	●
14	0.551	BT 40	1.732	M12	2.307	0.886	—	2.575	M16	GZ544311.14005	●
		BT 50	1.732	M12	3.236	0.886	—	4.008	M24	GZ546311.14008	●
16	0.630	BT 40	1.890	M14	2.819	0.945	—	2.575	M16	GZ544311.16007	●
		BT 50	1.890	M14	3.236	0.945	—	4.008	M24	GZ546311.16008	●
18	0.709	BT 40	1.969	M14	2.819	0.945	—	2.575	M16	GZ544311.18007	●
		BT 50	1.969	M14	3.236	0.945	—	4.008	M24	GZ546311.18008	●
20	0.787	BT 40	2.047	M16	2.819	0.984	—	2.575	M16	GZ544311.20007	●
		BT 50	2.047	M16	3.236	0.984	—	4.008	M24	GZ546311.20008	●
25	0.984	BT 40	2.559	M18 x 2	3.488	0.945	0.984	2.575	M16	GZ544311.25008	●
		BT 50	2.559	M18 x 2	3.906	0.945	0.984	4.008	M24	GZ546311.25009	●
32	1.260	BT 40	2.835	M20 x 2	3.724	0.945	1.102	2.575	M16	GZ544311.32009	●
		BT 50	2.835	M20 x 2	4.693	0.945	1.102	4.008	M24	GZ546311.32011	●